

The Force in Jointing Material Solutions

CONSEAL CS-231 - THE PRE-CAST CONCRETE JOINT SEAL

> PROPERTIES

- Conseal is a low expansion Butyl Bentonite based hydrophilic waterstop.
- It is manufactured utilising a special mixing process, which encapsulates the hydrophilic materials into a butyl rubber base thus creating a controlled moisture activated seal.
- Controlled expansion in the presence of water means that the Conseal will not soften to the point where it will extrude out of the joint.
- It is a highly elastic gasket with substantial movement capabilities. The heat of hydration ensures a chemical bond to green concrete.

> AREAS OF APPLICATION

- Conseal is the perfect product for sealing joints in pre-cast structures or between in-situ and pre-cast elements
- The Conseal will be compressed in the joint and provide an immediate seal. Its follow on expansion increases the seal and will accommodate small joint movements.
- Sealing strips for manholes, pipe penetrations and box culverts

CONSEAL CS231 - THE PRE-CAST CONCRETE JOINT SEAL

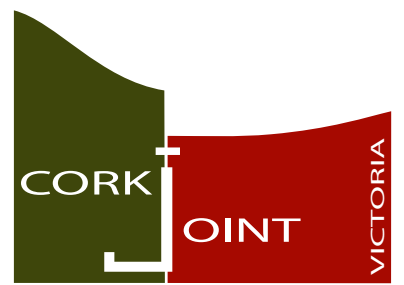

The Force in Jointing Material Solutions

> ADVANTAGES

- No site welding - just butt and mould together.
- Easy to handle - just prime the face of the concrete

> SURFACE FINISH REQUIRED

- For the best results it is recommended that a relatively smooth surface be provided along the line of the Conseal strip however a moderate amount of irregularity can be accommodated.

> INSTALLATION

- Carefully brush off all loose dust and dirt.
- Apply an approved primer to the area to which the Conseal is to be fixed. When the primer is cured firmly press the Conseal onto it ensuring that the Conseal alignment is to the Engineers specification.
- Apply moderate hand pressure using the heel of the hand and check that the Conseal is bonded to the primed strip.
- Remove the protective backing from the Conseal and knead together the overlapped ends at joints to form a continuous strip.
- Prime, likewise, the other matching surface and when cured bring the pre-cast section firmly together in the correct position.

> PLACEMENT IN THE JOINT

- Always ensure that there is a minimum of 50mm cover from the edge of the concrete to the face of the Conseal.

> STORAGE

- Conseal must be stored in cool DRY places. Any left over from site usage should be immediately returned to the original box and stored as above.

> PROFILE SIZES - Trapezoidal Shape

- 12mm x 25mm x 25mm
6 No. 5M rolls per box
Box weight: 21 kg
- 3mm x 15mm x 15mm
9 No. 6.5 M rolls per box
Box weight: 12 kg

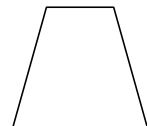

CONSEAL CS231 - THE PRE-CAST CONCRETE JOINT SEAL

> TECHNICAL DATA

> PHYSICAL PROPERTIES

DESCRIPTION	SPEC	CONSEAL
Color		Black
Specific Gravity	ASTM D -71	1.35 ±5
Hydrocarbon Content	ASTM D -4	47%
Volatile matter	ASTM D -6	1%
Penetration Cone @ 25 °C, 150gm, 5 Sec	ASTM D217	40 ±5
Application Temperature Range		-22 °C to 52 °C
Service Temperature Range		-34 °C to 82 °C

Total Expansion approx 40% in
28 days exposure to water.

Recommended Max Hydrostatic
Pressure 207kPa=21 M head

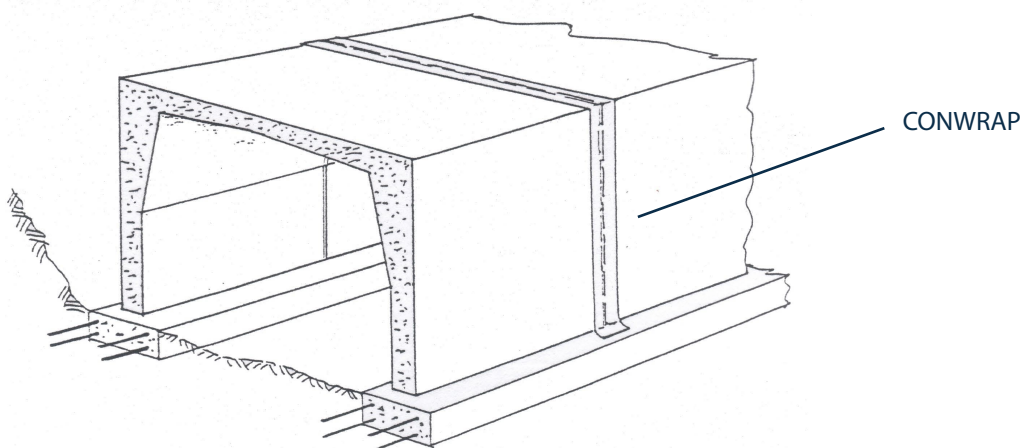

Example of use in precast inverted culvert or arch tunnels

**CONSEAL CS231 -
THE PRE-CAST CONCRETE JOINT SEAL**

> PHYSICAL PROPERTIES

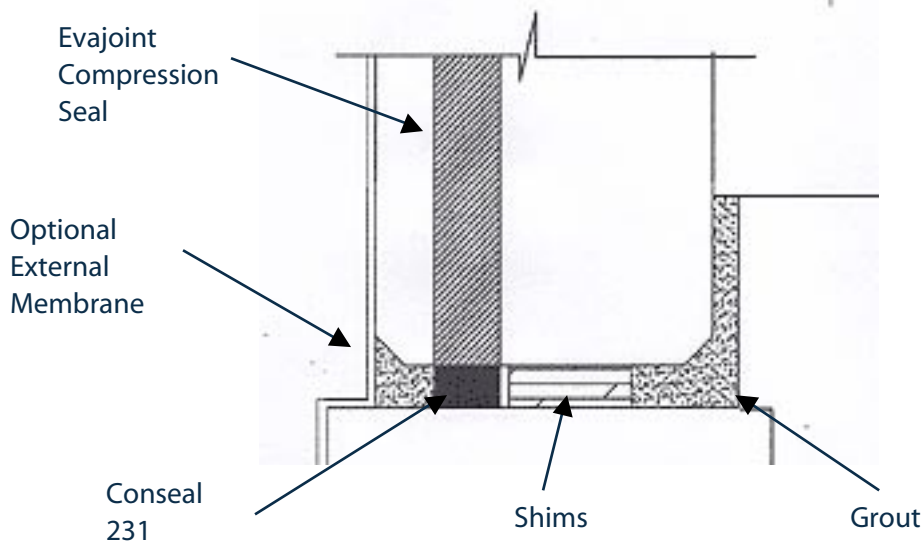
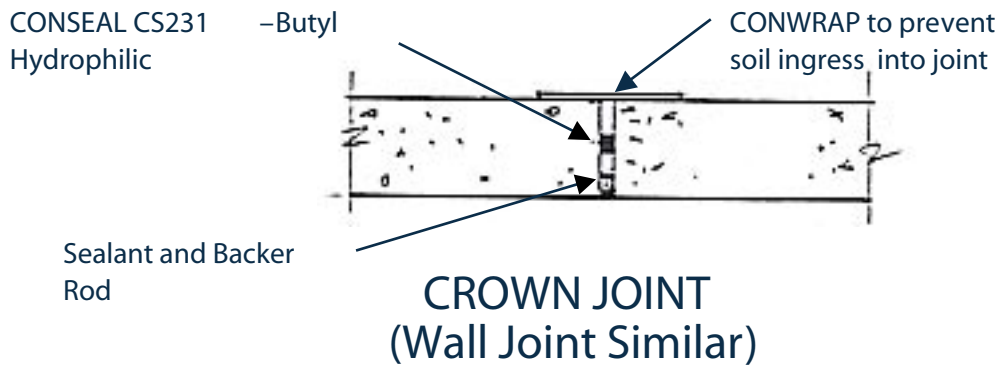

Corkjoint (Vic) Pty Ltd warrants that their products conform to the Specification of the Manufacturer and make no other warranty expressed or implied, including any warranty of merchantability or of fitness for a particular purpose. Further, data contained herein are typical laboratory results only and do not represent a guarantee of performance in any application. It is the customer's responsibility to satisfy himself that the product is fit for the purpose for which he intends to use it.